



LIFTING CLAMP for Concrete material (Carrying handle/Shackle type)

SKC 150 ~ 1250D

Ideal Clamps for lifting and handling of reinforced concrete U-shaped gutters, that are thick on one side, U-shaped flume channels and various reinforced concrete structures.

FEATURES

- Compact, lightweight and easy to handle
- The clamping force increases in proportion to the weight of the load.
- Simple jaw opening and closing mechanism
- A carrying handle type is also available for hand holding work with lightweight U-shaped gutters.
- High-frequency quenching of special alloy steels gives greater durability to the cam.



SKC (Carrying handle type)

SKC (Shackle type)

SKC-D (Deep & wide type)

EXAMPLES OF USE

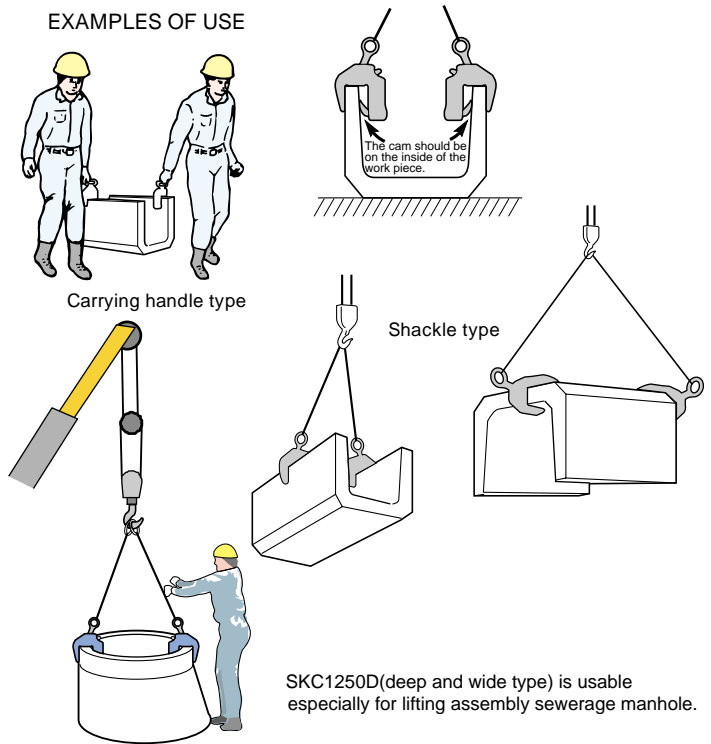

Carrying handle type

Shackle type

SKC1250D (deep and wide type) is usable especially for lifting assembly sewerage manhole.

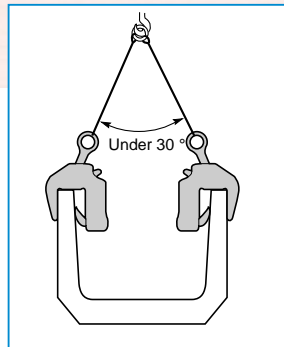

Always lift work pieces at 2 or more points for safety.

SPECIFICATIONS

Item No.	Model type	Rated capacity (kg)	Jaw opening (mm)	Weight (kg)
SKC 150	Carrying handle type	150	30 ~ 60	3
SKC 150M	Shackle type	150	30 ~ 60	3
SKC 250	Shackle type	250	50 ~ 80	3
SKC 250W	Shackle type	250	70 ~ 100	3.5
SKC 1250D	Deep & wide type	1250	73 ~ 137	10

DIMENSIONS TABLE

(Unit:mm)

Item No.	L	H	h ₁	h ₂	B	b ₁	b ₂	b ₃	T	T ₁	t	D ₁	D ₂
SKC 150	258 ~ 313	200	108	83	185	65	65	55	44.5	31	16	—	112
SKC 150M	258 ~ 332	200	108	83	185	65	65	55	44.5	31	10	50	70
SKC 250	278 ~ 332	205	120	85	190	66	85	39	44.5	32	10	50	70
SKC 250W	278 ~ 332	205	120	85	210	66	105	39	44.5	32	10	50	70
SKC 1250D	475 ~ 560	385	242	192	355	125	145	80	60	37	18	70	100

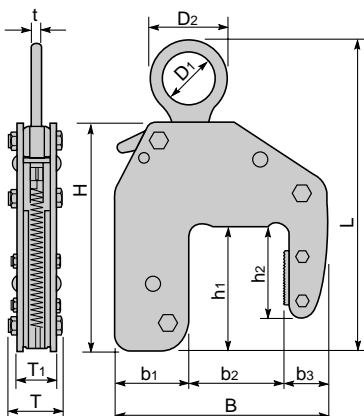

LIFTING CLAMPS FOR CONCRETE